

CAMPUS DIRECTORY

BUILDING LEGEND

NORTH CAMPUS

1. PRIOR HALL
3. WESTON D. BROWN (Dental Hygiene Clinic)
4. GLENN ANTHON HALL
6. SHERAR GYMNASIUM
7. RAYMOND HALL
8. DECIO HIGHER EDUCATION CENTER
9. HOPF UNION BUILDING (H.U.B.)
12. KENDALL HALL
13. LARSON GALLERY
16. SOCCER FIELD
17. DUNBAR FIELD (Softball)
19. PARKER FALLER FIELD (Baseball)

MECHANICAL

10. NORTH BOILER
11. CLOCK TOWER
14. PEDESTRIAN OVERPASS

SOUTH CAMPUS

20. PALMER MARTIN HALL
21. SUNDOQUIST HALL
22. NURSING BUILDING
23. NURSING ANNEX
24. TECHNOLOGY COMPLEX
25. RESOURCE CENTER
26. JANE'S HOUSE - CHILD CARE
28. CAMPUS OPERATIONS - SHOP
29. CAMPUS OPERATIONS
30. STUDENT RESIDENCE CENTER (S.R.C.) (Hopf Hall & Lyon Hall)
32. SKILLS CENTER
33. SKILLS CENTER ANNEX
34. ENGINEERING & PHYSICS CENTER
35. CENTRAL RECEIVING (Purchasing)

DR. LINDA KAMINSKI WEST CAMPUS

36. LARSON GALLERY & Y.V. VINTNERS
37. KAMINSKI ALLIED HEALTH CENTER
38. KAMINSKI CONFERENCE CENTER

PARKING LOT LEGEND

LTR. TYPE

- LOT A (STUDENT / STAFF)
- LOT B (STUDENT / STAFF)
- LOT C VISITOR PARKING
- LOT D ADMINISTRATION LOT
- LOT E (STUDENT / STAFF)
- LOT F (STUDENT / STAFF)
- LOT G FACULTY / STAFF MAIN LOT
- LOT H STUDENT MAIN LOT
- LOT I (STUDENT / STAFF)
- LOT J FACULTY / STAFF LOT
- LOT K STUDENT LOT
- LOT L (STUDENT / STAFF)
- LOT M FACULTY / STAFF LOT
- LOT N (STUDENT / STAFF)
- LOT O (STUDENT / STAFF)
- LOT P (STUDENT / STAFF)
- LOT Q (STUDENT / STAFF)
- LOT R (STUDENT / STAFF)
- LOT S FACULTY / STAFF LOT
- LOT T VISITOR / STAFF LOT



YVC YAKIMA CAMPUS

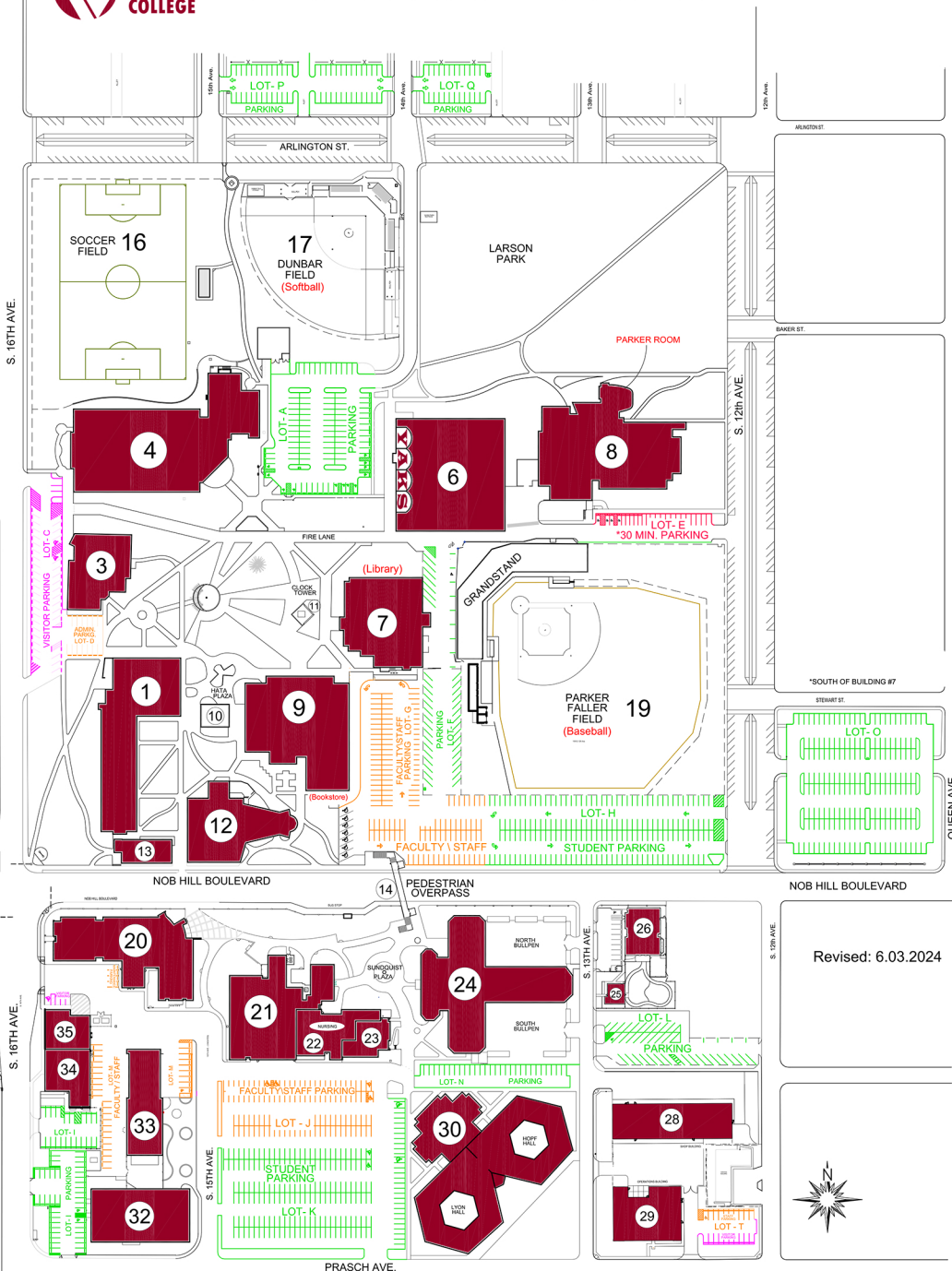

Revised: 6.03.2024

Yakima Valley College does not discriminate against any person on the basis of race, color, national origin, disability, sex, genetic information or age in admission, treatment, or participation in its programs, services and activities, or in employment. All inquires regarding compliance should be directed to the Human Resource Services Department, YVC, South 16th Ave. & Nob Hill Blvd., Yakima, Washington 98902 or call 509.574.4670.